



HOOK ADAPTERS

CLEVIS HOOKS

Clevis hooks feature a 15.9mm clevis for mounting to a standard Starrett clevis adapter. These hooks have a locking nut so you can rotate and position the hook for proper axial alignment. Hooks are available in a variety of sizes. Steel construction.

CLEVIS HOOKS

STEEL, HARDENED

- For general-purpose tensile testing applications
- Fasten to 15.9mm clevis adapters
- Operating Temperatures 32° to 158°F (0° to 70°C)

Clevis Hooks												
Model No.	Load Capacity			Material	Hook Wire Ø "A" mm	Hook Length "B"		Hook Radius "C"		Supply each	Clevis Size mm	
	N	KGf	LBF			in	mm	in	mm			
HOOK-231-3	350	35	78	Steel	3	2.8	70	0.2	6	1	15.9	
HOOK-231-5	1kN	100	225	Steel	5	3.3	83	0.4	10	1	15.9	
HOOK-231-8	2.5kN	250	560	Steel	8	4.7	120	0.6	16	1	15.9	
HOOK-231-12	6kN	600	1,350	Steel	12	6.4	161.6	0.9	24	1	15.9	

DIMENSIONS

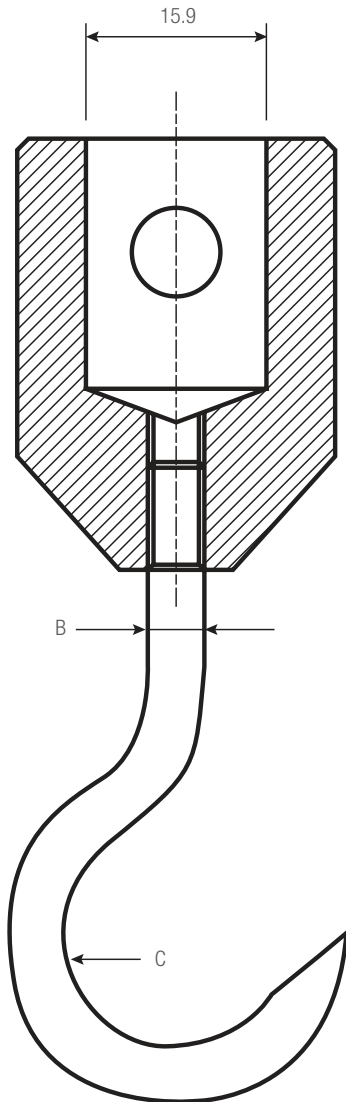

THREADED HOOKS

THREADED HOOKS

ALUMINUM AND STAINLESS STEEL

- For general-purpose tensile testing applications
- Threaded attachment
- Operating Temperatures 32° to 158°F (0° to 70°C)



Threaded Hooks										
Model No.	Load Capacity			Material	Thread Size		Hook Length		Supply	Wire Ø mm
	N	KGF	LBF		Female	Male	in	mm		
MLX-HOOK-XS	50	5	10	Aluminum	M6 x 1 - 6H	-	1.57	40	1	2.5
MLX-HOOK-S	500	50	100	Stainless Steel	-	M6 x 1 - 6g	1.73	44	1	6
MLX-HOOK-M	1500	150	330	Stainless Steel	-	M6 x 1 - 6g	2.6	66	1	6
MLX-HOOK-L	2500	250	500	Stainless Steel	-	M10 x 1.5-6g	3.9	99	1	6
MLX-HOOK-XL	2500	250	500	Stainless Steel	-	M12 x 1.75-6g	3.94	100	1	12

THREADED HOOK SWIVEL ADAPTER

STAINLESS STEEL

- Use with threaded hooks
- Allows for 360° hook rotation
- Operating Temperatures 32° to 158°F (0° to 70°C)



Swivel Adapters										
Model No.	Load Capacity			Thread Size Male Metric	Thread Size Female Metric	Material	Adapter Length (without hook)		Supply	
	N	KGF	LBF				in	mm		
MLX-SWIVEL	250	25	56	M6 x 1	M6 x 1-6H	Stainless	2.0	51	1	
MLX-SWIVEL-L	2,500	250	550	M10 x 1.5	M10 x 1.5-6H	Stainless	2.54	64.5	1	